

Instrukcja obsługi

HRQ-BUT-LM11

Controller HRQ-BUT-LM11, wireless 4-button controller allows to choose from 4 operating modes: Away, Home, Timer, Party. Range: 30 m (inside dwelling, 100 m in open space, additional antenna available).

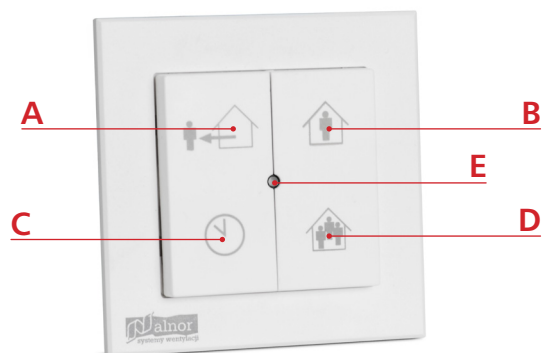

A: Away button
 B: Home button
 C: Timer button
 D: Boost button
 E: Status LED

1. General safety instructions

The device is designed for indoor use only. Do not expose the device to rain or moisture, to avoid short circuit. Short circuit may cause fire or electric shock hazard. Operate the device between 0°C and 40°C. For cleaning of the device use a soft damp cloth only. Never use any abrasive or chemical cleaner. Do not paint the device.

2. Intended use





The device is designed for the purpose to set the level of ventilation through the fan speed, based on user input. Every other or further use is not in conformance with the intended use.

3. Working principle

The device communicates with the control device using wireless communications, in order to control the ventilation. When you press a button, the device sends this information to the ventilation system. The ventilation system processes this request and sends the resulting status back to the device. The device shows the resulting status on the LED.

4. Ventilation speeds and modes

The ventilation system runs in one of the following modes. In each of these modes, the control device sets the ventilation system to a configured level of ventilation.

- **AWAY mode**  Low fan speed
- **HOME mode**  Medium fan speed
- **TIMER mode**  High fan speed, for a restricted duration
- **PARTY mode**  Highest fan speed (default 100%)

The control device drives the fan based on the highest of values sent by the bound wireless sensor(s). You can start the timer mode from this device for 30, 60 or 90 minutes (button pressed 1, 2 or 3 times).

5. Visuals signals

Startup	Status LED
Power up	Orange 1 flash

Status

OK	Green
Low battery	Orange 1 flash
Dirty filter	Orange 2 flashes
Fan error	Red 2 flashes

Interaction response

Mode changed	Green 1 flash
Binding succeeded	Green 2 flashes
Communication error	Red 1 flash

6. Installation



NOTE:

Do not place the device in a metal casing.

If not placing on a flush mounted wall box, prepare the wall:

1. Pull the buttons from the unit (fig. 1)
2. Loosen the clips and separate the unit from the mounting plate (fig. 2)
3. If using screws: prepare the wall, if needed. Use the mounting plate as a template.
4. If using tape:
 - a. Remove the foil from the double-sided tape.
 - b. Make sure that the surface is flat & clean.

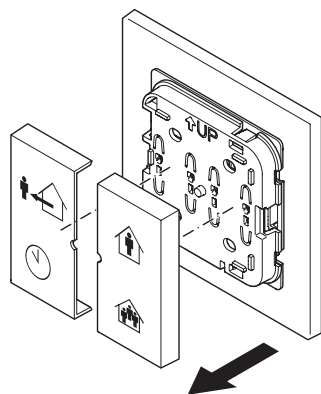

Figure 1 - pull the buttons from the unit

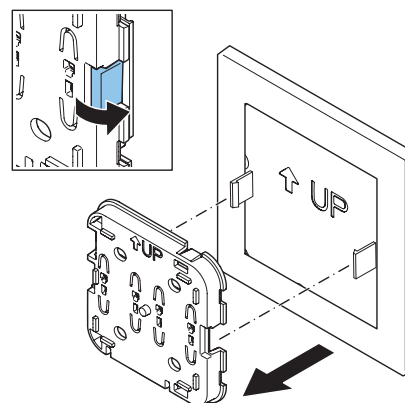

Figure 2 - loosen the clips and separate the unit from the mounting plate

HRQ-BUT-LM11

Installation procedure:

1. Place device / mounting plate
2. If using screws: fasten the mounting plate using the screws (fig .3).
3. Place the device onto the mounting plate (fig. 4).
4. Place the buttons (fig. 5).

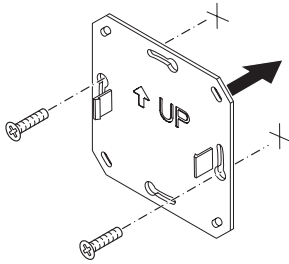

Figure 3 - mounting plate

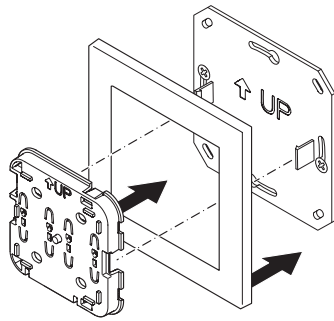

Figure 4 - place the device onto the mounting plate

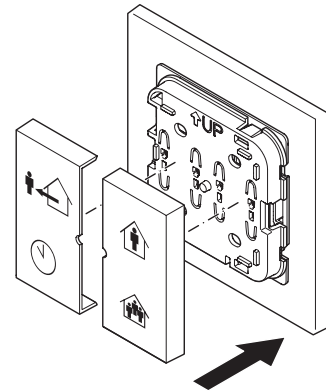

Figure 5 - place the buttons

Commissioning:

1. Make sure the HRU is in binding mode.
2. Press and hold the two upper or two lower buttons. The device tries to bind to the unit. It shows the result on the status LED.

7. Operation

Press the required button.

For button C:

- press 1x for 30 minutes
- press 2x for 60 minutes
- press 3x for 90 minutes

The device shows the result on the status LED.

8. Dirty filter reset

To reset the dirty filter message, press and hold AWAY and PARTY for at least 4 seconds.

9. Replacing the battery

(See section 5 for more visual instructions)

1. Remove the buttons from the unit.
2. Loosen the clips and separate the unit from the mounting plate.
3. Replacing the battery (fig. 6)
 - a. Remove the old battery.
 - b. Place the new battery.The LED shortly shows orange.
4. Place the device onto the mounting plate.
5. Place the buttons.

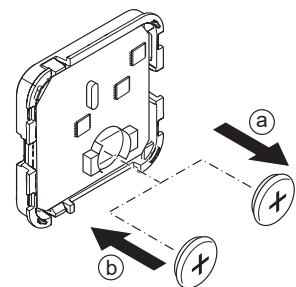

Figure 6 - replacing the battery

HRQ-BUT-LM11

10. Technical data

- Dimensions
 - Overall dimensions: 84 x 84 x 15 mm (H x W x D)
 - Weight: ± 125g
- Ambient conditions
 - Operating Temperature Range: 0 to 40°C
 - Shipping & Storage Temperature Range: -20 to 55°C
 - Relative Humidity: 0 - 90%, non-condensing
 - Ingress protection (IEC60529): IP30
- Battery specification:
 - Type: CR2032
 - Battery lifetime: 6 years
- Wireless connection specifications
 - Communication frequency: 868.3 MHz
 - Output power: at least 0 dBm.

You are not allowed to use the device outside of Europe.